

**Non-Skive Swage Ferrule for Braided Hose Series 15011**

**A**

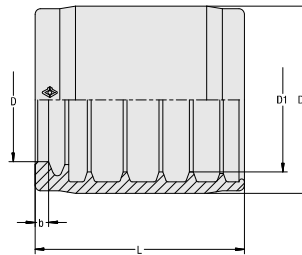

**Suitable for Standards** 1SN, 2SN, 2SC, 2SN-K  
EN 853, EN 857

**Material** Carbon Steel  
**Surface Finishing** Zinc/Nickel-Plating *Δplus*

Maximum working pressures depending on the type of the hose connector and the hose type.

Hose Size			Dimensions (mm/in)					Weight (kg/lbs) ca. per 100	VOSWINKEL Part Numbers	STAUFF Ordering Codes
DN	inch	Dash	D	D1	D2	L	b			
05	1/8"	-03	9,8	12,5	17,0	27,3	2,0	1,7	15110N05 1SN	HF-1001-05-W3
			,39	,49	,67	1,07	,08	3,64		
05	1/8"	-03	9,8	14,0	18,6	27,3	2,0	2,0	15220N05 2SN	HF-1002-05-W3
			,39	,55	,73	1,07	,08	4,30		
06	1/4"	-04	11,8	15,7	21,0	31,0	2,5	2,6	15011N06	HF-1000-06-W3
			,46	,62	,83	1,22	,10	5,62		
08	5/16"	-05	13,2	17,3	22,5	31,0	2,5	2,7	15011N08	HF-1000-08-W3
			,52	,68	,89	1,22	,10	5,84		
10	3/8"	-06	15,5	19,8	26,5	33,0	2,5	4,7	15011N10	HF-1000-10-W3
			,61	,78	1,04	1,30	,10	10,25		
12	1/2"	-08	19,2	23,0	30,0	36,0	2,5	5,7	15011N12	HF-1000-12-W3
			,76	,91	1,18	1,42	,10	12,57		
16	5/8"	-10	22,5	26,2	34,0	38,0	2,5	7,8	15011N16	HF-1000-16-W3
			,89	1,03	1,34	1,50	,10	17,09		
19	3/4"	-12	25,5	30,1	38,0	44,0	3,0	10,4	15011N20	HF-1000-19-W3
			1,00	1,19	1,50	1,73	,12	22,82		
25	1"	-16	32,8	38,8	47,0	52,0	3,7	16,4	15011N25	HF-1000-25-W3
			1,29	1,53	1,85	2,05	,15	36,16		
31	1 1/4"	-20	40,5	49,3	57,0	60,0	4,0	21,1	15011N32	HF-1000-31-W3
			1,59	1,94	2,24	2,36	,16	46,53		
38	1 1/2"	-24	46,6	55,8	65,0	73,0	4,3	37,5	15011N40	HF-1000-38-W3
			1,83	2,20	2,56	2,87	,17	82,58		
51	2"	-32	58,9	68,5	78,0	80,0	4,3	50,0	15011N50	HF-1000-51-W3
			2,32	2,70	3,07	3,15	,17	110,25		

**Related Products and Accessories**



**DORNVOS Test Mandrels** Pages 185-187

